

- About Us
- Location Near You
- Making your Deal
- Warranty and Service
- Testimonials
- Financing FAQ
- Quick Quote



Extreme Extreme Mega-light Companion

Extreme 5thWheels

- [330 FX](#)
- [380 FX](#)

Get a QUOTE Right Now

If your looking for the right equipment for your business or leisure time, heres the way to get started.



QUICK Instant Financing

Its easier and less hassle free than you've ever imagined. The only thing keeping you from the RV of your dreams is your imagination.

Let go and let's go!



Extreme Model 330FX 5th Wheel

This Extreme 34 footer sleeps 6-10, and has a wide array of options to outfit your Extre like it.

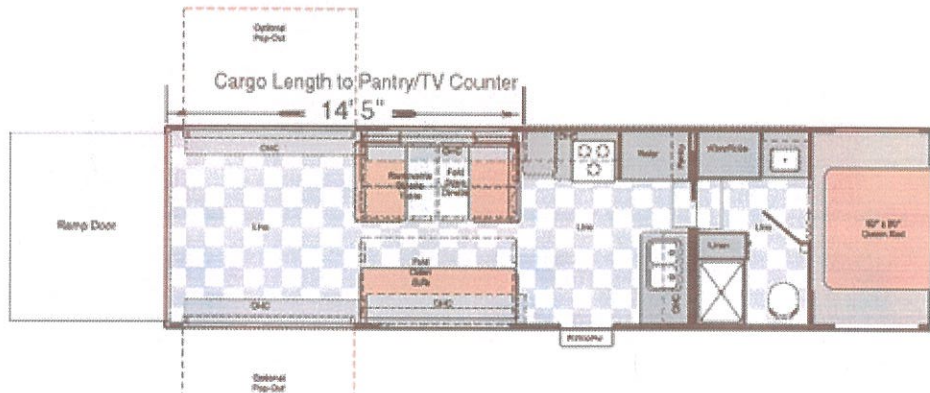

Capacity

- ✓ ● Sleeping Accommodations 6-10
- ✓ ● Furnace 31M
- ✓ ● Fresh Water 110
- ✓ ● Holding Black Water 35
- ✓ ● Holding Gray Water 1 40

Tires

- ✓ ● Tire Size ST225/75R15 2540# 65PSI
- ✓ ● Tire Count 6 *BALANCED*

Weights

- Dry Overall 9780
- Hitch 2110
- G.V.W.R 15500
- Carrying Capacity ' 5720



Size

- Length (exterior) 34'8"
- Width (exterior) 102 "
- Height (exterior) 12'1"
- Height (interior) 101"



Living & Dining Features

- ✓● Valances with Mini Blinds (color interior specific)
- ✓● Free-Standing Dinette Table
- ✓● Modern Kitchen Appliances including:
 - ✓● 3-burner Range, 21" Oven, with Range Cover & Hood
 - 6 cu. ft. Double-Door Refrigerator
 - Flip-up Table at End of Range (model specific)
 - ✓● Double-Bowl Sink with High-Rise Faucet
 - ✓● Pantry (model specific)
 - Interior Assist Handle (white)
 - ✓● Diamond Plate Kick Plate along walls
 - ✓● Wall-Mount, Monitor panel (probe)



Bedroom & Bath Features

- ✓● Foot-Flush Toilet
- ✓● Tissue Holder, Towel Bar, Towel Ring
- ✓● Wall/Door Mirror in Bathroom (model specific)
- ✓● Queen Bed with Deluxe Mattress
- ✓● Pull-Down Queen Bed in Rear Cargo Area
- ✓● Shower Curtain
- ✓● Roof Vent w/ 12v Fan in Bathroom



Misc Features:

- ✓● Living room TV Jack (120v recep, 12v & booster) & TV ant.
- ✓● Park Cable & Satellite TV (DSS) Ready (main TV location)
- ✓● Smoke alarm, Fire extinguisher, LP gas detector
- ✓● City water inlet
 - 6 Gal gas/elec DSI Water Heater (12v only)
 - 60 Gal. Fresh Water
- ✓● Water Heater By-pass & Water Pump (2.8 gpm)
- ✓● Water Tank Fill with Std. Inlet (water tanks below floor)
- ✓● Forced Air Furnace (model specific)
- ✓● Roof Vent – Kitchen, Bedroom, & Cargo Area (model specific)

Interior Systems

- ✓● In-floor Heat Duct (model specific)
- ✓● 40 Amp, 12v Electronic Converter/Charger
 - 30 Amp Service Center & 10/3 30 Amp Power Cord
 - 50 Amp Service Center & 6/4 50 Amp Cord (380FXU)
- ✓● Interior Speakers, 4 each (upgraded)
 - Installed TV Systems

Construction Features

- ✓ • Walk-on Rubber Roof
- ✓ • R-18 Insulation in Roof & R-7 Insulation in Walls & Floors

Exterior Systems

- ✓ • 100" Wide Body
- ✓ • Easy crank underfloor spare tire carrier mounted on chassis
- ✓ • Shocks Installed
- ✓ • Leveling Jacks & Power Jacks (fw)
 - TT Coupler - 13,000# with 5/16" ball (fifth wheels 20,000 lb.)
- ✓ • Sewer Hose Carrier
- ✓ • Lighting – 2 Utility, 4 Patio, 4 Round Tail lights
- ✓ • Rack & Ladder Installed (Front Ladder)
- ✓ • Outside Wash Station
- ✓ • 1 Patio Outlet (120v duplex recept)
- ✓ • Extra Large Elec. Cable Door
- ✓ • Radius Entry Door with T-catch
- ✓ • Flush-Mount Entry Door Lock with Dead Bolt
- ✓ • Exterior SUPER Storage with 1" Baggage Doors
- ✓ • Tinted Windows
- ✓ • Spare Tire (standard wheel)
- ✓ • A&E 8300 Awning *UPGRADED*

OPTIONS

- ✓ • Flip-up Dinette (roadside) & Flip-up Sofa (curbside) P1 & P2
- ✓ • Ceiling-mounted Paddle Fan P2
- ✓ • Microwave installed (1.0), built-in
- ✓ • Bedspreads (Front Bedroom & Pull-Down Beds) P1 & P2
- ✓ • Tub/Shower surround P1 & P2
- ✓ • AM/FM Stereo & CD Player with Digital Tuner P1 & P2
- ✓ • 10 Gal gas/elec DSI Water Heater (12v only) P1 & P2
- ✓ • 110 Gal. Fresh Water P1 & P2 *220 TOTAL*
- ✓ • 13.5m Non-Ducted or Ducted A/C Installed (TT) P1 & P2
 - Metal Skin with Graphics & Diamond Plate P1
- ✓ • Large Exterior Assist Handle - folding P1 & P2
- ✓ • Dual 7-gal LPG Cylinders with Cover (travel trailers) P1 & P2
- ✓ • Aluminum Frame Construction P1 & P2
- ✓ • High Gloss Filon Gelcoat with Graphics & Diamond Plate P2
 - A&E 8500 Color Matched Awning P2
- ✓ • Removable Carpet
- ✓ • Rear Screen Canvas Add-a-Wall
- ✓ • Screened Room for Rear Ramp
- ✓ • 8 cu. ft., Double-door Refrigerator
- ✓ • Power Jack - TT
- ✓ • 15.0 m Non-ducted or ducted A/C installed (FW) P1 & P2
 - Water purifier with Faucet
 - CSA (vapor-tight divider wall, no awning, gas tank, or fuel station)

SPECIALIZED OPTIONS

- ✓ • Ice Maker (Stand Alone) with Water Purifier P2
- ✓ • Exterior Speakers P1 & P2
- ✓ • Exterior Flood Lights P2
- ✓ • Walkie Talkie (4) w/charger P2

- Outside Barbeque P2
- ✓ Gas Tank & Fuel Station installed P1 & P2 (only w/fuel dispensing station) (NO w/CSA option)
- ✓ Generator Ready for Built-in P1 & P2 (includes galv. liner, vented access door, 30A recept & overcurrent)
 - Generator Installed (Onan 5.5), Built-in (goes with gas tank installed option, om
 - Canvas Tip-Out, (one or two sides - model specific)

P1 - Package Option # 1 - Metal Exterior

P2 - Package Option # 2 - Fiberglass Exterior

EXTREMETOYHAULER.COM

14166 SLOVER AVENUE FONTANA CALIFORNIA 909.434.2522 or toll free-1.866.599.3355

[About](#) | [Location](#) | [Companion](#) | [Extreme](#) | [Monterey](#) | [Contact](#) | [Sitemap](#)

ADD ONS:

BUILT IN GENERATOR. 3000 INVERTER

AIR COMPRESSOR

2 - 110 WATT SOLAR PANNELS

AUTO REGULATOR + SWITCH

2750 WATT POWER INVERTER - 5000 WATT PEAK.

REAR MAN DOOR 4W FOLD OUT STEPS

LONG CHECKER FLAG AWNING

SATELLITE DISH

3 - 6 VOLT DEEP CYCLE BATTERIES - 4 IN TOTAL.

LARGE JACK BASES (NO NEED FOR BLOCKING)

USED 1 SUMMER - MINT CONDITION.

\$ 45,000.00.

PADDY 780-778-0388